



## Property Data

STRAP: 25-44-23-C4-00930.0010 Folio ID: 10082805

Generated on 10/5/2023 3:07 PM

## Owner Of Record - Sole Owner

[\[Change Address\]](#)

INTERNATIONAL CAPITAL INVESTME  
20 N MARTINGALE RD STE 180  
SCHAUMBURG IL 60173

## Site Address

Site Address maintained by [E911 Program Addressing](#)

2107/2119 SANTA BARBARA BLVD  
CAPE CORAL FL 33991

## ALTERNATE ADDRESS INFORMATION:

2119 SANTA BARBARA BLVD

## Property Description

Do not use for legal documents!



CAPE CORAL UNIT 26 BLK 930 PB 14 PG 140 LOTS 1-12 + 100-110 +  
N 30 FT LOTS 7 + 104 + VAC ALLEY RES OR 4744/3540

[\[ Tax Map Viewer \]](#)
[\[ View Comparables \]](#)
[\[ Pictometry Aerial Viewer \]](#)

## Current Working Values

[Hurricane Ian Tax Roll Value Letter](#)[Tax Refund Status](#)

Just 8,773,282

## Attributes

Land Units Of Measure	SF
Units	122957.00
Total Number of Buildings	2
Total Bedrooms / Fixtures (multiple buildings, see Appraisal Details below)	0 / 36
Gross Building Area (multiple buildings, see Appraisal Details below)	34,843
1st Year Building on Tax Roll	2006
Historic Designation	No

## Image of Structure

[◀ Photo Date December of 2018 ▶](#)
☐ View other photos

Last Inspection Date: 01/09/2019

Exemptions / Classified Use (Current)

Generated on 10/5/2023 3:07 PM

Exemptions / Classified Use (2023 TRIM)

Generated on 10/5/2023 3:07 PM

Values (2023 TRIM)

Generated on 10/5/2023 3:07 PM

Taxing Authorities

Generated on 10/5/2023 3:07 PM

[Sales / Transactions](#)

Generated on 10/5/2023 3:07 PM

**Building / Construction Permit Data**  
Generated on 10/5/2023 3:07 PM

**Parcel Numbering History** ⓘ  
Generated on 10/5/2023 3:07 PM

**Location Information**  
Generated on 10/5/2023 3:07 PM

**Solid Waste (Garbage) Roll Data**  
Generated on 10/5/2023 3:07 PM

**Flood and Storm Information**  
Generated on 10/5/2023 3:07 PM

**Address History**  
Generated on 10/5/2023 3:07 PM

**Appraisal Details (2023 TRIM)**  
Generated on 10/5/2023 3:07 PM

<b><u>Appraisal Details (Current Working Values)</u></b>			
Generated on 10/5/2023 3:07 PM			
Land			
Land Tracts			
Use Code	Use Code Description	Number of Units	Unit of Measure
8300	Government Owned, Public School	122957.00	Square Feet
Land Features			
Description		Year Added	Units
BLACK TOP - IMPROVED		2006	30,847
BLACK TOP - IMPROVED		2013	7,800
FENCE - CHAIN LINK - 6 FOOT		2013	260
WALL - DECORATIVE - C.B.S.		2006	240
PAVEMENT - CONCRETE		2006	60
FENCE - ALUM/VINYL - 4 FEET		2006	77
FENCE - ALUM/VINYL - 6 FEET		2006	13
SLAB - CONCRETE		2006	182
Buildings			
Building 1 of 2			
Building Characteristics			
Improvement Type	Model Type	Stories	Living Units

90 - School	9 - EDUCATIONAL/RECREATIONAL		2.0	0
Bedrooms	Bathrooms		Year Built	Effective Year Built
0	0.0		2006	2006
Building Subareas				
Description			Heated / Under Air	Area (Sq Ft)
BAL - BALCONY			N	24
BAS - BASE			Y	8,238
FOP - FINISHED OPEN PORCH			N	441
FUS - FINISHED UPPER STORY			Y	9,927
LBA - LOBBY AVERAGE			Y	1,302
PTO - PATIO			N	763
Building Features				
Description			Year Added	Units
SPRINKLER SYSTEM (INTERIOR)			2006	16,339
ELEVATOR - PASSENGER			2006	2
TELLER WINDOWS			2006	1
CANOPY/FACADE			2006	151

Building Front Photo



Photo Date: November of 2017

Building Footprint

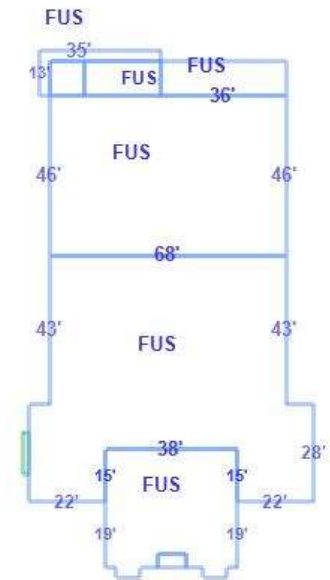
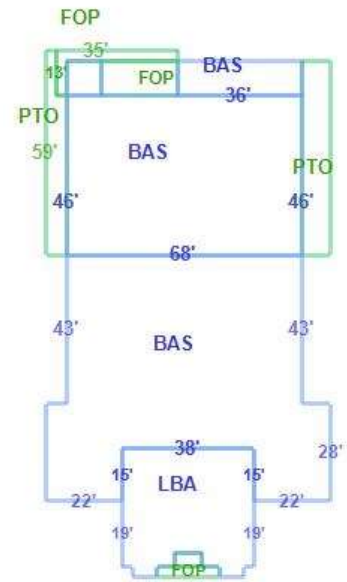

**Building 2 of 2**  
**Building Characteristics**

**Improvement Type**

90 - School

**Model Type**

9 - EDUCATIONAL/RECREATIONAL

**Stories**

1.0

**Living Units**

0

**Bedrooms**

0

**Bathrooms**

0.0

**Year Built**

2013

**Effective Year Built**

2013

**Building Subareas**

**Description**

**Heated / Under Air**

**Area (Sq Ft)**

BAS - BASE	Y	15,376
FOP - FINISHED OPEN PORCH	N	578

**Building Front Photo**



**Photo Date: December of 2018**

**Building Footprint**

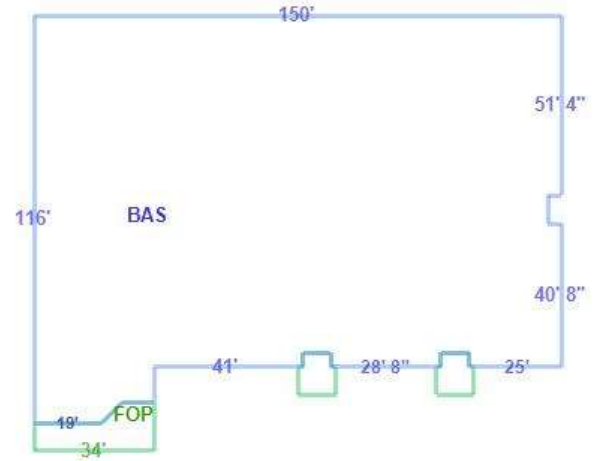

[Previous Parcel Number](#)  
[Next Parcel Number](#) [New](#)  
[Query](#) [Search Results](#)

Generated on 10/5/2023 3:07 PM

TRIM (proposed tax) Notices are available for the following tax years

[ [2007](#) [2008](#) [2009](#) [2010](#) [2011](#) [2012](#) [2013](#) [2014](#) [2015](#) [2016](#) [2017](#) [2018](#) [2019](#) [2020](#) [2021](#) [2022](#) [2023](#) ]  
[Home](#)